

VTECH[®]

LITTLE SMART[®]



learning center

USER'S MANUAL



© VTECH
Printed in China
91-01073-000 (美)

Dear Parent:

At VTech® we know that children have the ability to do great things. That's why all of our electronic learning products are uniquely designed to develop a child's mind and allow them to learn to the best of their ability. Whether it's learning about letters, numbers, geography or algebra, all VTech® learning products incorporate advanced technologies and extensive curriculum to encourage children of all ages to reach their potential.

When it comes to providing interactive products that enlighten, entertain and develop minds, at VTech® we see the potential in every child.

INTRODUCTION

Thank you for purchasing the **VTECH® LITTLE SMART® Learning Center** toy. This product is one of a family of **LITTLE SMART®** educational electronic learning products. We at **VTECH®** are committed to providing the best possible products to entertain and educate your child. Should you have any questions or concerns, please call our Consumer Services Department at 1-800-521-2010 in the U.S. or 1-800-267-7377 in Canada, or 01235-546810 in the U.K..

The **LITTLE SMART® Learning Center** is an electronic activity center that features letters, numbers, objects and shapes and is designed to make learning fun.

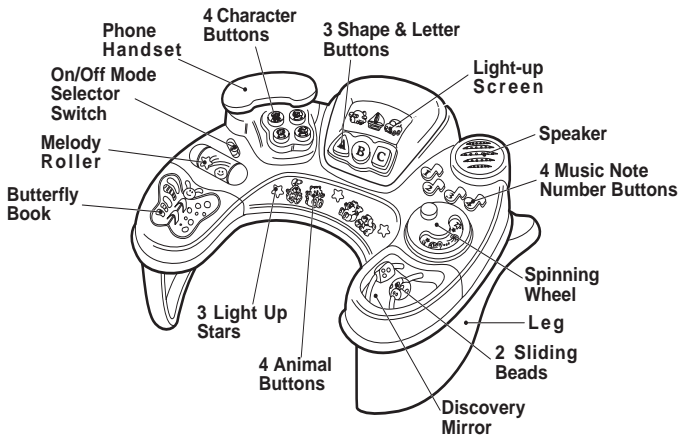

INCLUDED IN THIS PACKAGE

- One **LITTLE SMART® Learning Center** toy.
- One instruction manual.

WARNING: All packing materials, such as tape, plastic sheets, wire ties and tags are not part of this toy and should be discarded for your child's safety.

BATTERY INSTALLATION

1. Make sure the unit is **Off**.
2. Locate the battery cover on the back of the **LITTLE SMART® Learning Center** toy. Use a coin or screwdriver to open the battery cover.
3. Install 2 new 'AA' (UM-3/LR6) batteries, as illustrated. (The use of alkaline batteries is recommended for maximum performance.)
4. Replace the battery cover and tighten the screw to secure the battery cover.

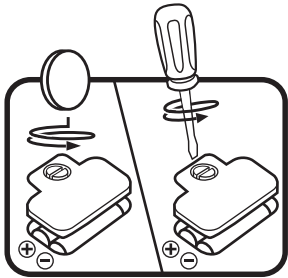

BATTERY NOTICE

- Install batteries correctly observing the polarity (+, -) signs to avoid leakage.
- Do not mix old and new batteries.
- Do not use batteries of different types.
- Remove exhausted or new batteries from the unit when the unit will not be used for an extended period of time.
- Do not dispose of batteries in fire.
- Do not attempt to recharge ordinary batteries.
- The supply terminals are not to be short-circuited.

WE DO NOT RECOMMEND THE USE OF RECHARGEABLE BATTERIES.

NOTE: If the **LITTLE SMART® Learning Center** toy suddenly stops working, the voice becomes faint or the sound seems weak, the problem may be low battery power. If this is the case, follow the steps below:

1. Turn the unit **Off** for a moment, then back **On**.
2. Check to make sure the batteries are properly inserted.
3. Try inserting brand new batteries.

If, after following the above steps, you are still having a problem with the unit, please call our Consumer Services Department at 1-800-521-2010 in the U.S., 1-800-267-7377 in Canada or 01235-546810 in the U.K., and a service representative will be happy to help you.

ASSEMBLY INSTRUCTIONS

STEP 1

Place the table top upside down on a flat surface. Follow the direction of the arrows by inserting one leg into the recessed area as shown in Figure 1. Please make sure the leg fits securely into the recessed area.

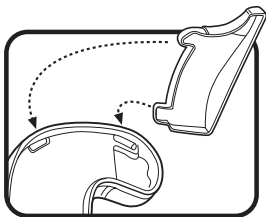
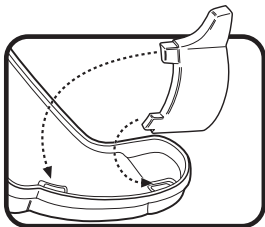

Figure 1.

STEP 2

Repeat the above instructions for the remaining leg .



NOTE: WE RECOMMEND THAT THIS PRODUCT BE ASSEMBLED BY AN ADULT.

TO BEGIN PLAY

1. Slide the **On/Off/Mode Selector Switch** to the **Talking Mode** (☺) or **Music Mode** (🎵) position. You will hear a short tune and the lights will flash randomly.

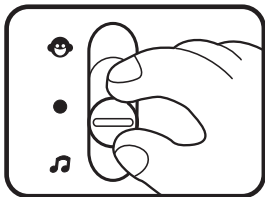

2. Slide the **On/Off/Mode Selector Switch** to the **Off** (●) position to turn off the unit.

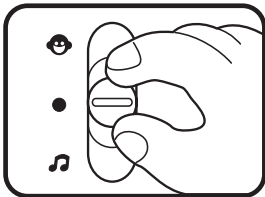

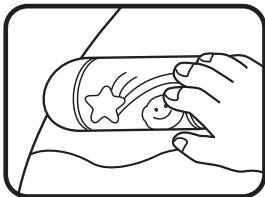

3. Spin the **Melody Roller** to hear a cheerful melody .



4. Turn the **Spinning Wheel** to hear a fun sound effect and see pictures of friendly animals.

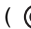

5. To adjust the volume, slide the **Volume Control Switch**, located on the back of the unit, to the **Low Volume** () position or **High Volume** () position.

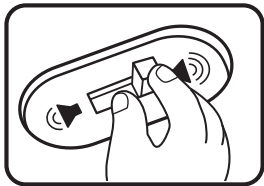

6. Turn the pages of the **Butterfly Book** to see the different patterns.

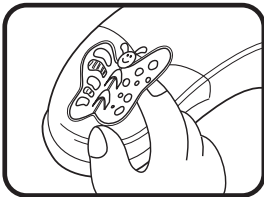

7. Move the cute insect **Sliding Beads** along the bead paths. Look into the **Discovery Mirror** to see your reflection.

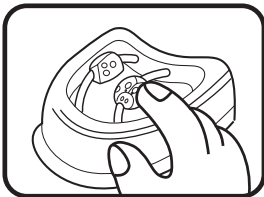

ACTIVITIES

A. Talking Mode

1. Slide the **On / Off Mode Selector Switch** to the **Talking Mode** () position. You will hear a short tune.

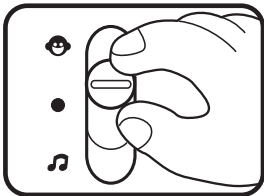

2. Press any **Shape & Letter Button** to hear the object on the screen identified.
to hear the object on the screen identified.
Watch the object light-up and hear a fun sound effect.

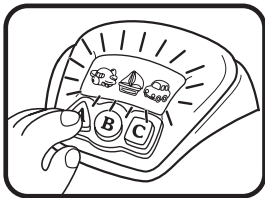

3. Press an **Animal Button** to hear the animal identified and see the light-up stars flash.



4. Press a **Character Button** to hear a fun sound effect and the friendly character identified. The **Phone Handset** can be lifted for fun pretend phone play.

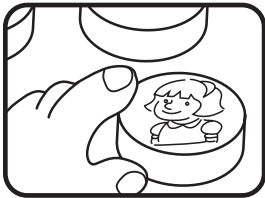

5. Press a **Music Note / Number Button** to hear the number identified .

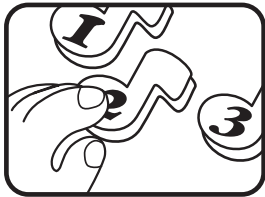

B. Music Mode

1. Slide the **On / Off Mode Selector Switch** to the **Music Mode** (🎵) position. You will hear a short tune.

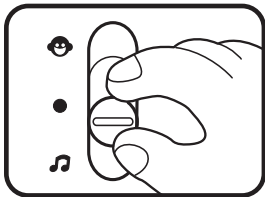

2. Press any **Shape & Letter Button** to hear the shape identified. The screen will light-up and you will hear a short melody.

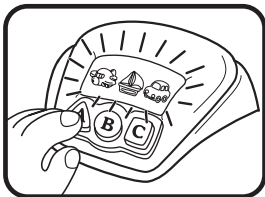

3. Press any **Animal Button** to hear the animal sound effect /short tune and see the light-up stars flash.



4. Press the **Character Buttons** to hear cheerful melodies.

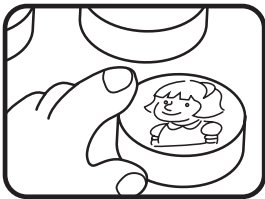

5. Press a **Music Note / Number Button** to hear one of the music note sounds and see the stars flash.

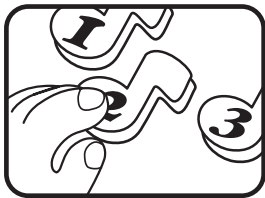

AUTOMATIC SHUT-OFF

To preserve battery life, the **LITTLE SMART® Learning Center** toy will automatically turn off after several minutes without input. The unit can be turned on again by pressing any button (except the **Volume Control Switch**).

CARE AND MAINTENANCE

1. Keep the unit clean by wiping it with a slightly damp cloth.
2. Keep the unit out of direct sunlight and away from any direct heat source.
3. Remove the batteries when the unit is not in use for an extended period of time.
4. Do not drop the unit on hard surfaces and do not expose the unit to moisture or water.

IMPORTANT NOTE

Creating and developing Infant/Toddler products is accompanied by a responsibility that we at **VTECH**[®] take very seriously. We make every effort to ensure the accuracy of the information which forms the value of our products. However, errors sometimes can occur. It is important for you to know that we stand behind our products and encourage you to call our Consumer Services Department at 1-800-521-2010 in the U.S., 1-800-267-7377 in Canada or 01235-546810 in the U.K. with any problems and/or suggestions that you might have. A service representative will be happy to help you.

Note:

This equipment generates and uses radio frequency energy and if not installed and used properly, that is, in strict accordance with the manufacturer's instructions, it may cause interference to radio and television reception. It has been type tested and found to comply within the limits for a Class B computing device in accordance with the specifications in Sub-part J of Part 15 FCC Rules, which are designed to provide reasonable protection against such interference in a residential installation. However, there is no guarantee that interference will not occur in a particular installation. If this equipment does cause interference to radio or television reception, which can be determined by turning the equipment off and on, the user is encouraged to try to correct the interference by one or more of the following measures:

- reorient the receiving antenna
- relocate this product with respect to the receiver
- move this product away from the receiver